

**SCHEDULE OF MATERIALS**

- ① - MACADAM SURFACING (CAR PARKING SPACES)  
- THERMOPLASTIC PAINT LINING ETC.  
- COLOUR - BLACK/GREY SELF COLOUR  
- WHITE LINING TO DEMARCAT BAYS
- ② - CONCRETE SURFACING  
- COLOUR - LIGHT GREY SELF COLOUR
- ③ - MACADAM SURFACING (ROADWAY)  
- THERMOPLASTIC PAINT LINING ETC.  
- COLOUR - BLACK/GREY SELF COLOUR
- ④ - CONCRETE BLOCK PAVING  
- MARSHALLS KEYBLOK PAVING  
- COLOUR - BRINDLE
- ⑤ - CONCRETE BLOCK PAVING  
- MARSHALLS KEYBLOK PAVING  
- COLOUR - BUFF
- ⑥ - CONCRETE SLAB PAVING  
- MARSHALLS STANDARD PIMPLE PAVING  
- COLOUR - NATURAL
- ⑦ - STRUCTURED LANDSCAPING  
- SCHEME TO BE APPROVED BY LOCAL AUTHORITY  
- PRIOR TO IMPLEMENTATION
- ⑧ - PROPRIETARY FABRICATED STEEL CYCLE SHELTER  
- SURFACE COATED IN PROPRIETARY FINISH  
- SIZE 5000 (L) X 2140MM (W) X 2150 (H)  
- CAPACITY - 10x12 CYCLES PER SHELTER  
- COLOUR - ANTHRACITE GREY
- ⑨ - 2.4M HIGH PALADIN FENCE  
- SURFACE COATED IN PROPRIETARY FINISH  
- COLOUR - BLACK
- ⑩ - FABRICATED STEEL PEDESTRIAN/VEHICULAR GATES/CONTROL BARRIER  
- FULL SPECIFICATION PPC FINISH  
- COLOUR - BLACK
- ⑪ - 100 x 100mm TREATED TIMBER KNEE RAIL, 450mm HIGH  
FIXED TO TREATED TIMBER POSTS WITH GALV. STRAPS, TOP END OF POSTS  
TO BE NOTCHED TO RECEIVE TOP RAIL.
- ⑫ - 4.0M TIMBER ACOUSTIC FENCE  
WITH MAINTENANCE ACCESS GATES
- ⑬ - 4.8M TIMBER ACOUSTIC FENCE  
WITH MAINTENANCE ACCESS GATES
- ⑭ - 6.0M TIMBER ACOUSTIC FENCE WITH  
1M CANTILEVER, WITH MAINTENANCE  
ACCESS GATES

**NOTES:**  
 Ordnance Survey © Crown Copyright 2022. All rights reserved. Licence number 100022432  
 The Contractor is to check and verify all building and site dimensions, levels and sewer invert levels at connection points before work starts. The Contractor is to comply in all respects with current Building Legislation, British Standard Specifications, Building Regulations, Construction (Design & Management) Regulations, Party Wall Act, etc. whether or not specifically stated on this drawing. This drawing must be read with and checked against any structural, geotechnical or other specialist documentation provided.  
 This drawing is not intended to show details of foundations, ground conditions or ground contaminants. Each area of ground relied upon to support any structure depicted (including drainage) must be investigated by the Contractor. A suitable method of foundation should be provided allowing for existing ground conditions. Any suspect or fluid ground, contaminants on or within the ground, should be further investigated by a suitable expert. Any earthwork constructions shown indicate typical slopes for guidance only & should be further investigated by a suitable expert.  
 Where existing trees are to be retained they should be subject to a full Arboricultural inspection for safety. All trees are to be planted so as to ensure they are a minimum of 5 metres from buildings and 3 metres from drainage and services. A suitable method of foundation is to be provided to accommodate the proposed tree planting.  
 Sketch proposals are for illustrative purposes only & as such are subject to detailed site investigation including ground conditions / contaminants, drainage, design & planning / density negotiations. Sketch proposals may be based upon enlargements of OS sheets & visual estimations of existing site features; accuracy will therefore need to be verified by survey. Sketch proposals have not been considered in respect of CDM Regulations.

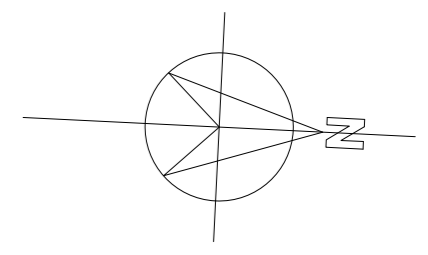

P07	SL	02-10-2024	Service yard arrangement amended inline with plot 1 wide updates.
P06	RJF	23-04-2024	Lorry parking omitted and 99No carpark spaces added to service yard area.
P05	RJF	05-03-2024	Dim added from C/L of Turnip Lock to building and acoustic fence.
P04	RJF	22-02-2024	1/2m added to double back lorry spaces as planners request.
P03	RJF	31-08-2023	C/A site boundary colour changed from Blue to Red. Development plot boundary omitted.
P02	RJF	04-04-2023	Acoustic fence details updated to "Air & Acoustic Consultants" requirements.
P01	RJF	10-03-2023	Planning Drawing Issue.
Rev:	Drawn:	Date:	Description:

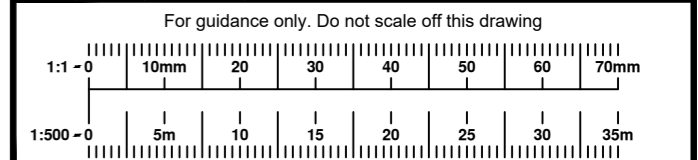

**bhpdesign**  
 a bhpgroup company  
 Birmingham  
 B3 1FQ, United Kingdom  
 t: +44(0)121 314 6618  
 w: bhp-design.co.uk

**CLIENT:** MRE MERCIA REAL ESTATE

**PROJECT:** PROPOSED DEVELOPMENT AT FORMER GKN FACILITY HADLEY PARK EAST TELFORD

**TITLE:** PROPOSED SITE PLAN UNIT 1 (Sheet 2 of 2)

<b>Drawing Status:</b>	PLANNING DRAWINGS		
<b>Job No:</b>	21-142	<b>Drg No:</b>	P-10-2
<b>Scale @ A2:</b>	1:500	<b>Date:</b>	Sept 22
<b>Drawn By:</b>	RJF	<b>Checked By:</b>	DB
		<b>Orig:</b>	A2

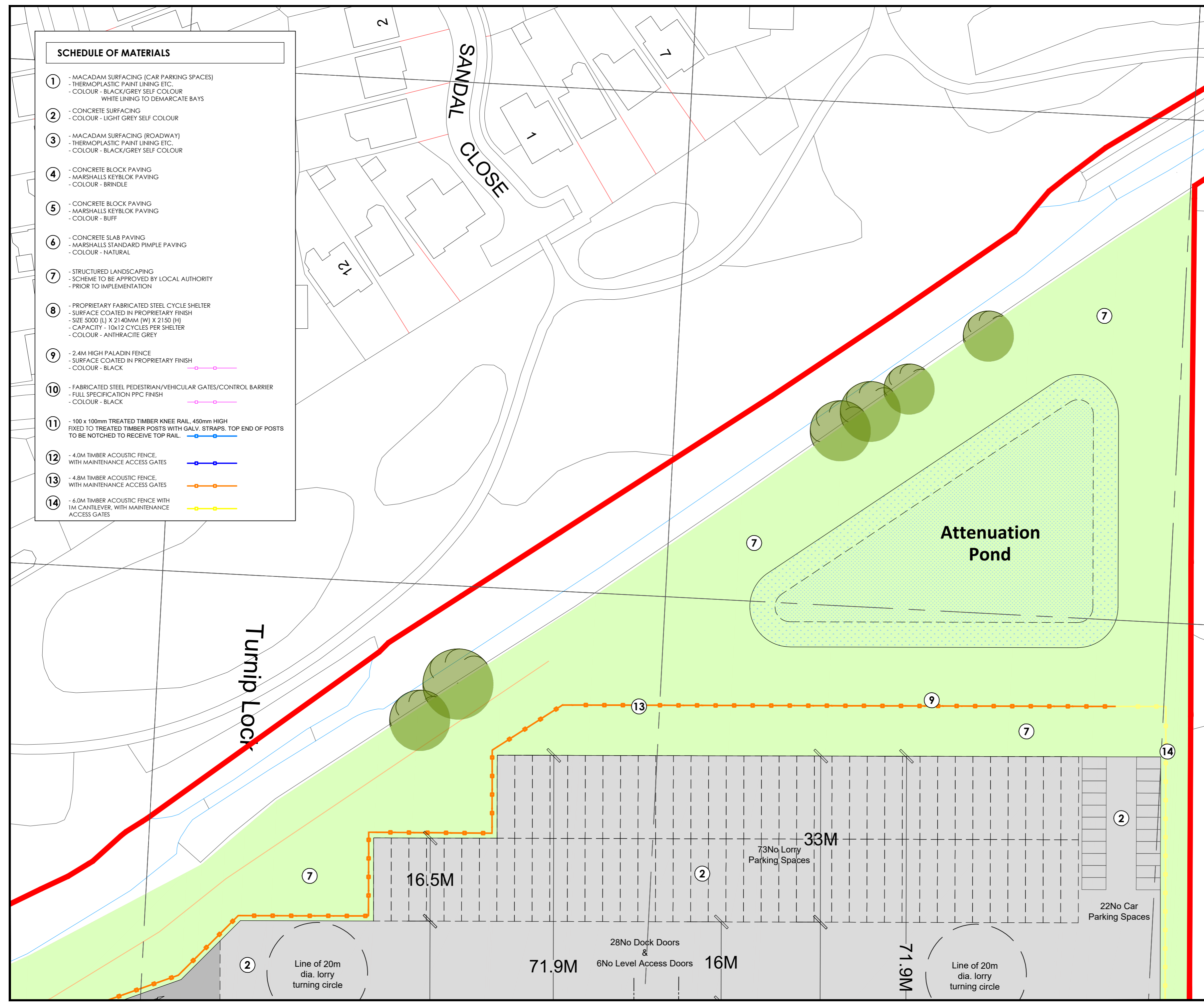

© This drawing and the building works depicted are the copyright of BHP Design (UK) LTD. and may not be reproduced or amended except by written permission. No liability will be accepted for amendments made by other persons.