

THIS DRAWING IS TO BE READ IN CONJUNCTION WITH ALL RELATED DRAWINGS. ALL DIMENSIONS MUST BE CHECKED AND VERIFIED ON SITE BEFORE COMMENCING ANY WORK OR PRODUCING SHOP DRAWINGS. THE ORIGINATOR SHOULD BE NOTIFIED IMMEDIATELY OF ANY DISCREPANCY. THIS DRAWING IS COPYRIGHT AND REMAINS THE PROPERTY ROGER PARRY & PARTNERS.

Rev	Description	Date	By
A	Bund & additional planting added	08/09/2023	NB
B	Revised following Planner's comments	27/11/2023	NB
C	Planting revised	09/02/2024	NB

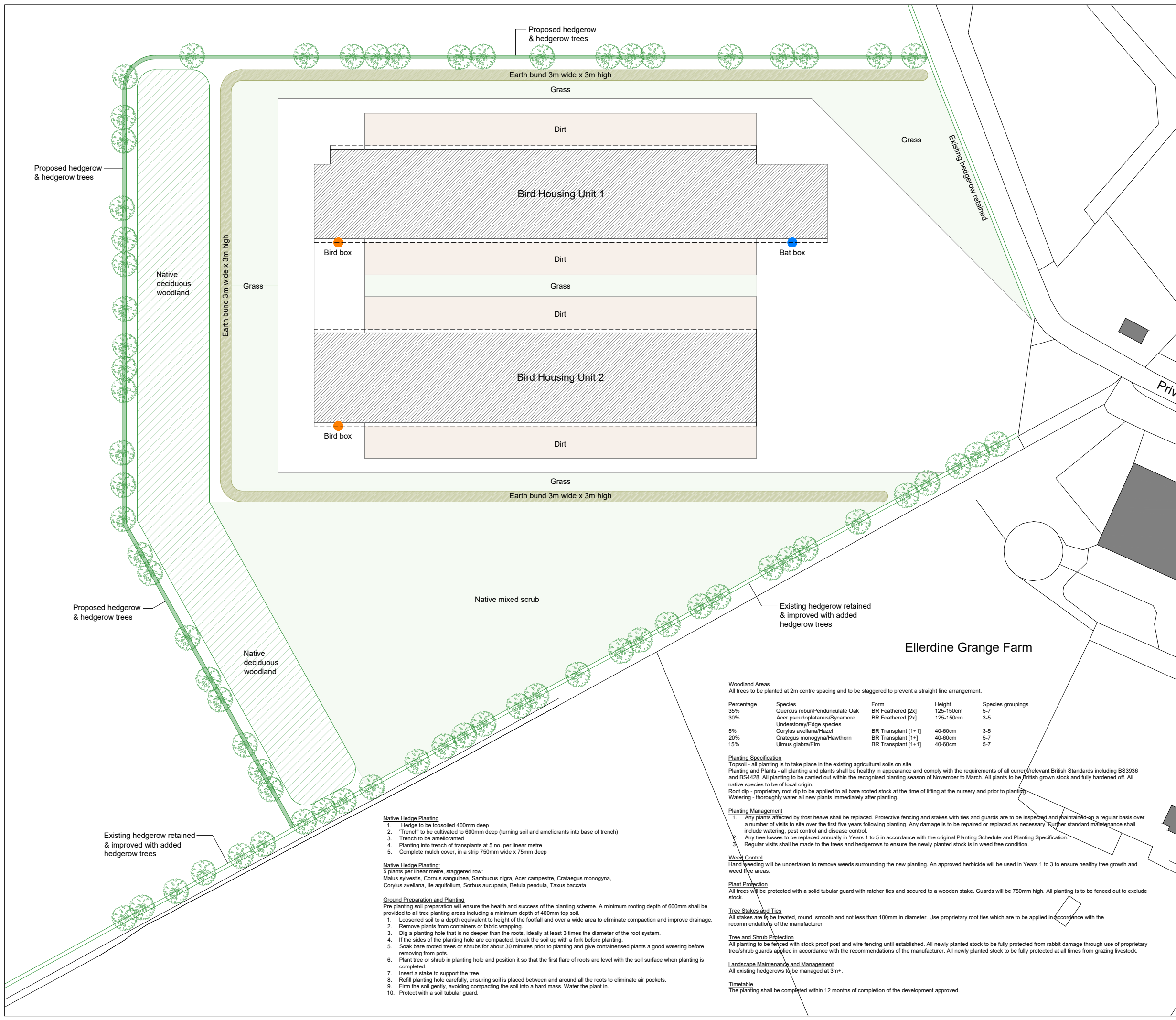

Woodland Areas
All trees to be planted at 2m centre spacing and to be staggered to prevent a straight line arrangement.

Percentage	Species	Form	Height	Species groupings
35%	Quercus robur/Pendunculate Oak	BR Feathered [2x]	125-150cm	5-7
30%	Acer pseudoplatanus/Sycamore	BR Feathered [2x]	125-150cm	3-5
5%	Corylus avellana/Hazel	BR Transplant [1+1]	40-60cm	3-5
20%	Crataegus monogyna/Hawthorn	BR Transplant [1+]	40-60cm	5-7
15%	Ulmus glabra/Elm	BR Transplant [1+1]	40-60cm	5-7

Planting Specification
Topsoil - all planting is to take place in the existing agricultural soils on site.
Planting and Plants - all planting and plants shall be healthy in appearance and comply with the requirements of all current relevant British Standards including BS9336 and BS4428. All planting to be carried out within the recognised planting season of November to March. All plants to be British grown stock and fully hardened off. All native species to be of local origin.
Root dip - proprietary root dip to be applied to all bare rooted stock at the time of lifting at the nursery and prior to planting.
Watering - thoroughly water all new plants immediately after planting.

Planting Management
1. Any plants affected by frost heave shall be replaced. Protective fencing and stakes with ties and guards are to be inspected and maintained on a regular basis over a number of visits to site over the first five years following planting. Any damage is to be repaired or replaced as necessary. Further standard maintenance shall include watering, pest control and disease control.
2. Any tree losses to be replaced annually in Years 1 to 5 in accordance with the original Planting Schedule and Planting Specification.
3. Regular visits shall be made to the trees and hedgerows to ensure the newly planted stock is in weed free condition.

Weed Control
Hand weeding will be undertaken to remove weeds surrounding the new planting. An approved herbicide will be used in Years 1 to 3 to ensure healthy tree growth and weed free areas.

Plant Protection
All trees will be protected with a solid tubular guard with ratchet ties and secured to a wooden stake. Guards will be 750mm high. All planting is to be fenced out to exclude stock.

Tree Stakes and Ties
All stakes are to be treated, round, smooth and not less than 100mm in diameter. Use proprietary root ties which are to be applied in accordance with the recommendations of the manufacturer.

Tree and Shrub Protection
All planting to be fenced with stock proof post and wire fencing until established. All newly planted stock to be fully protected from rabbit damage through use of proprietary tree/shrub guards applied in accordance with the recommendations of the manufacturer. All newly planted stock to be fully protected at all times from grazing livestock.

Landscape Maintenance and Management
All existing hedgerows to be managed at 3m+.

Timetable
The planting shall be completed within 12 months of completion of the development approved.

Native Hedge Planting
1. Hedge to be topped to 400mm deep
2. 'Trench' to be cultivated to 600mm deep (turning soil and ameliorants into base of trench)
3. Trench to be ameliorated
4. Planting into trench of transplants at 5 no. per linear metre
5. Complete mulch cover, in a strip 750mm wide x 75mm deep

Native Hedge Planting:
5 plants per linear metre, staggered row:
Malus sylvestris, Cornus sanguinea, Sambucus nigra, Acer campestre, Crataegus monogyna, Corylus avellana, Ilex aquifolium, Sorbus aucuparia, Betula pendula, Taxus baccata

Ground Preparation and Planting
Pre planting soil preparation will ensure the health and success of the planting scheme. A minimum rooting depth of 600mm shall be provided to all tree planting areas including a minimum depth of 400mm top soil.
1. Loosened soil to a depth equivalent to height of the footfall and over a wide area to eliminate compaction and improve drainage.
2. Remove plants from containers or fabric wrapping.
3. Dig a planting hole that is no deeper than the roots, ideally at least 3 times the diameter of the root system.
4. If the sides of the planting hole are compacted, break the soil up with a fork before planting.
5. Soak bare rooted trees or shrubs for about 30 minutes prior to planting and give containerised plants a good watering before removing from pots.
6. Plant tree or shrub in planting hole and position it so that the first flare of roots are level with the soil surface when planting is completed.
7. Insert a stake to support the tree.
8. Refill planting hole carefully, ensuring soil is placed between and around all the roots to eliminate air pockets.
9. Firm the soil gently, avoiding compacting the soil into a hard mass. Water the plant in.
10. Protect with a soil tubular guard.



Residential - Agricultural - Commercial

Project	Proposed Egg Laying Unit		
Drawing Title	Landscaping & Biodiversity Plan		
Location	Oaklands Eggs, Ellerdine Grange, Ellerdine, Shropshire, TF6 6QR		
Client	J A & O Griffiths		
Scale	1:1000 @ A3		
Drawing No	76993 / RJC / 005	Rev	C
Drawn By	NB	Date	2023/02/16

HOGSTOW HALL, MINSTERLEY SHREWSBURY, SHROPSHIRE. SY5 0HZ
Tel: 01743 791336 Fax: 01743 792770
E-mail: mail@rogerparry.net
Web address: www.rogerparry.net
Roger Parry & Partners LLP partnership no. OC312203
Registered Office Hogstow Hall, Minsterley, Shrewsbury, SY5 0HZ
Registered in England and Wales.
A list of members of the LLP is available at the above address.